

# OSHPD Seismic Ratings: Community Hospital, Long Beach California

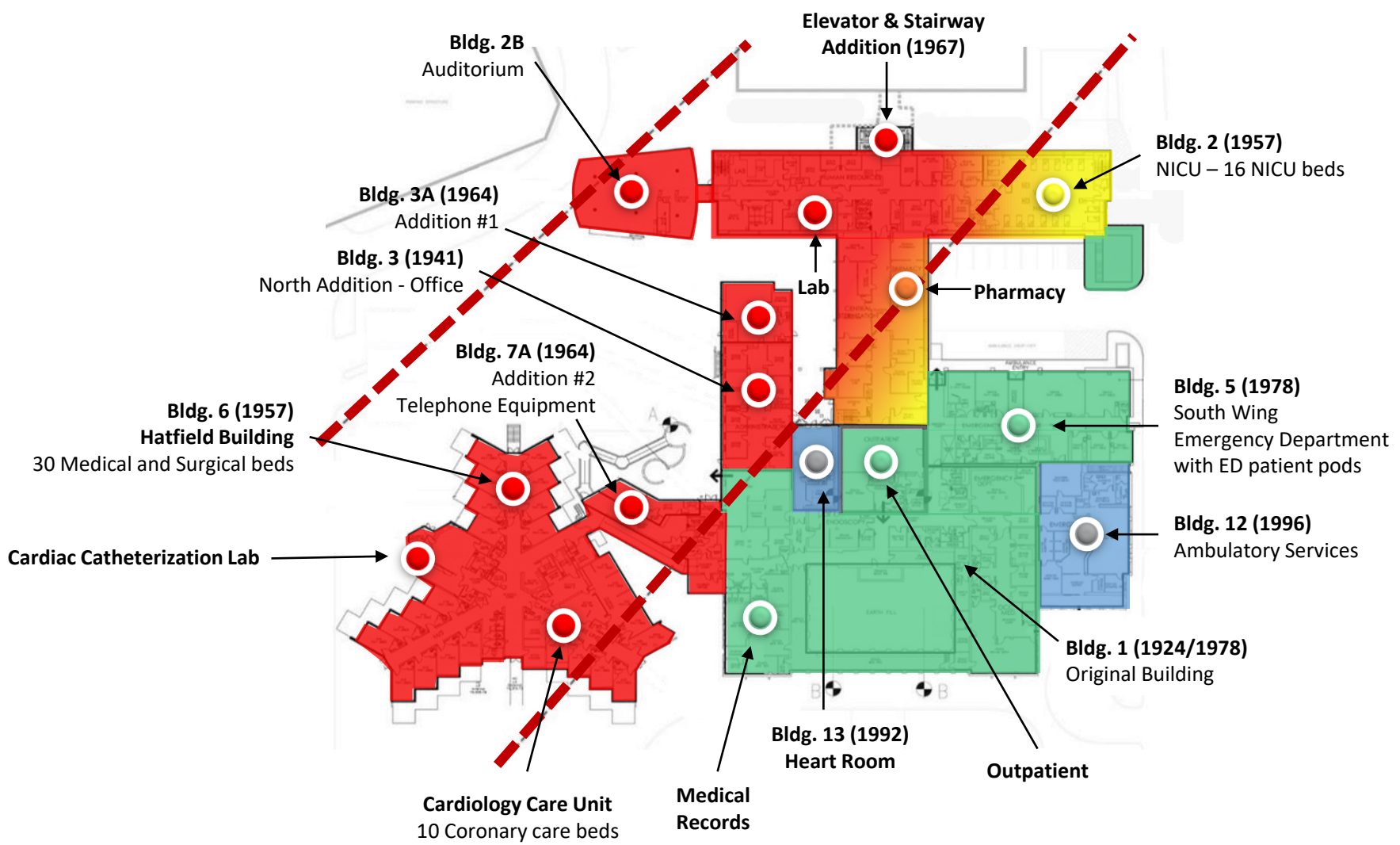

- - - - Parameters of the Splay fault line
- 1** Pose significant risk of collapse and danger to the public.
- 2** Does not significantly jeopardize life, but may not be repairable or functional following strong ground motion.
- 3** May experience structural damage which does not significantly jeopardize life, but may not be repairable or functional following strong ground motion.
- 4** May experience structural damage which may inhibit ability to provide services to the public following strong ground motion.
- 5** Reasonably capable of providing services to the public following strong ground motion.