



Wrigley Greenbelt Project

Virtual Community Meeting

April 7, 2021



CITY OF
LONG BEACH

Wrigley Greenbelt Meeting Ground Rules

- **Please submit questions in the chat box.**
- **Staff will be addressing questions after the presentation.**
- **This presentation will be available on the Project's webpage:
www.longbeach.gov/wrigleygreenbeltproject**

Wrigley Greenbelt Meeting Agenda

- **Welcome and Introductions**
- **Wrigley Greenbelt History & Overview**
- **Project Objectives & Scope**
- **Tree & Landscape Summary**
- **Rendering – 34th Street Entrance Rest Area**
- **Conservation Corps of Long Beach (CCLB) Partnership**
- **Project Construction Timeline**
- **Questions**

Wrigley Greenbelt Overview

- This is Los Angeles County Department of Public Works Los Angeles River Flood Control excess land outside the river levees.
- Wrigley Greenbelt Master Plan developed in 1993.
- Project engagement started in 2007 as part of the Long Beach RiverLink Plan.
- Corresponding engagement and community outreach took place in 2009, 2010, 2011, 2013, 2015 and 2021.

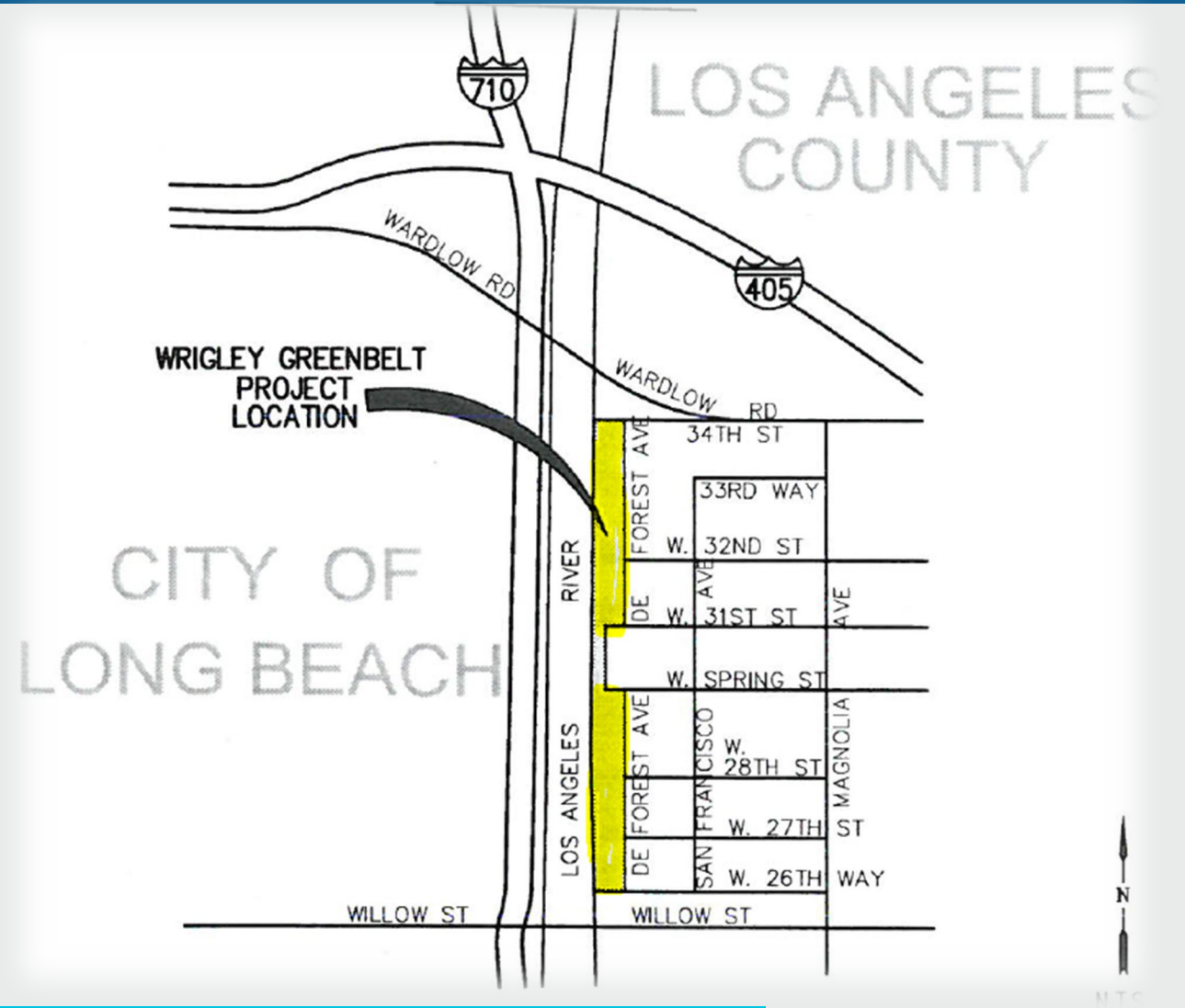

Wrigley Greenbelt Overview

- In 2008, City of Long Beach was awarded two Grants from the Los Angeles County Regional Park and Open Space District (LACRPOSD) for this Wrigley Greenbelt Project:
 - Grant No. 58F5-14-2432 - \$625,000
 - Grant No. 58F5-08-2173 - \$1,000,000
 - Grants include task descriptions for the development of Wrigley Greenbelt including DG trail, equestrian rest station, streambed crossings, landscaping with native plants, and other amenities.
- Both Grants expire on July 15, 2021
- In 2019 the Conservation Corps of Long Beach (CCLB) agreed to partner on this project and provide additional funding required to complete the Greenbelt through Cal Fire grants secured by CCLB.
- Public Works reviewed and modified original plan to accomplish the project goals with limited funding and resources.

Project Scope & Objectives (Cont.)

Objectives

- Improve visitor experience and pedestrian connectivity along the LA River
- Improve air quality from green buffer along I-710 corridor, leading to increased health of residents
- Encourage outdoor and recreational experience
- Restoration and preservation of Wrigley Greenbelt Open Space

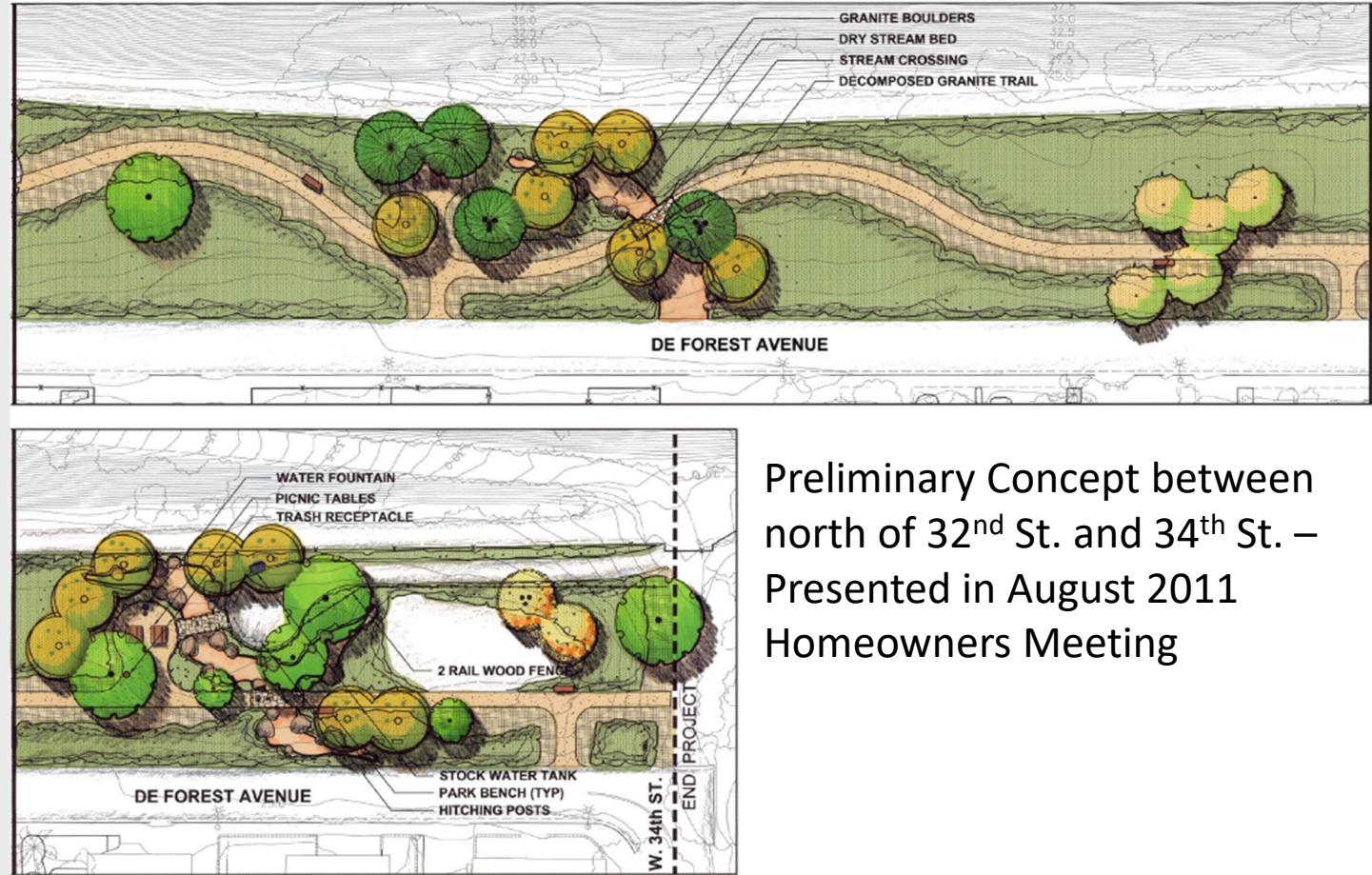

Preliminary Concept between north of 32nd St. and 34th St. – Presented in August 2011 Homeowners Meeting

Project Scope & Objectives

Scope

- 6'0" wide decomposed granite (DG) walking trail throughout Greenbelt
- Install new native landscaping including shrubs, ground cover, and over 2:1 replacement of trees, as well as new irrigation system
- Dry stream beds to improve stormwater runoff control and drainage into surrounding soil
- New site furnishings, including benches, picnic table rest areas, and water fountains

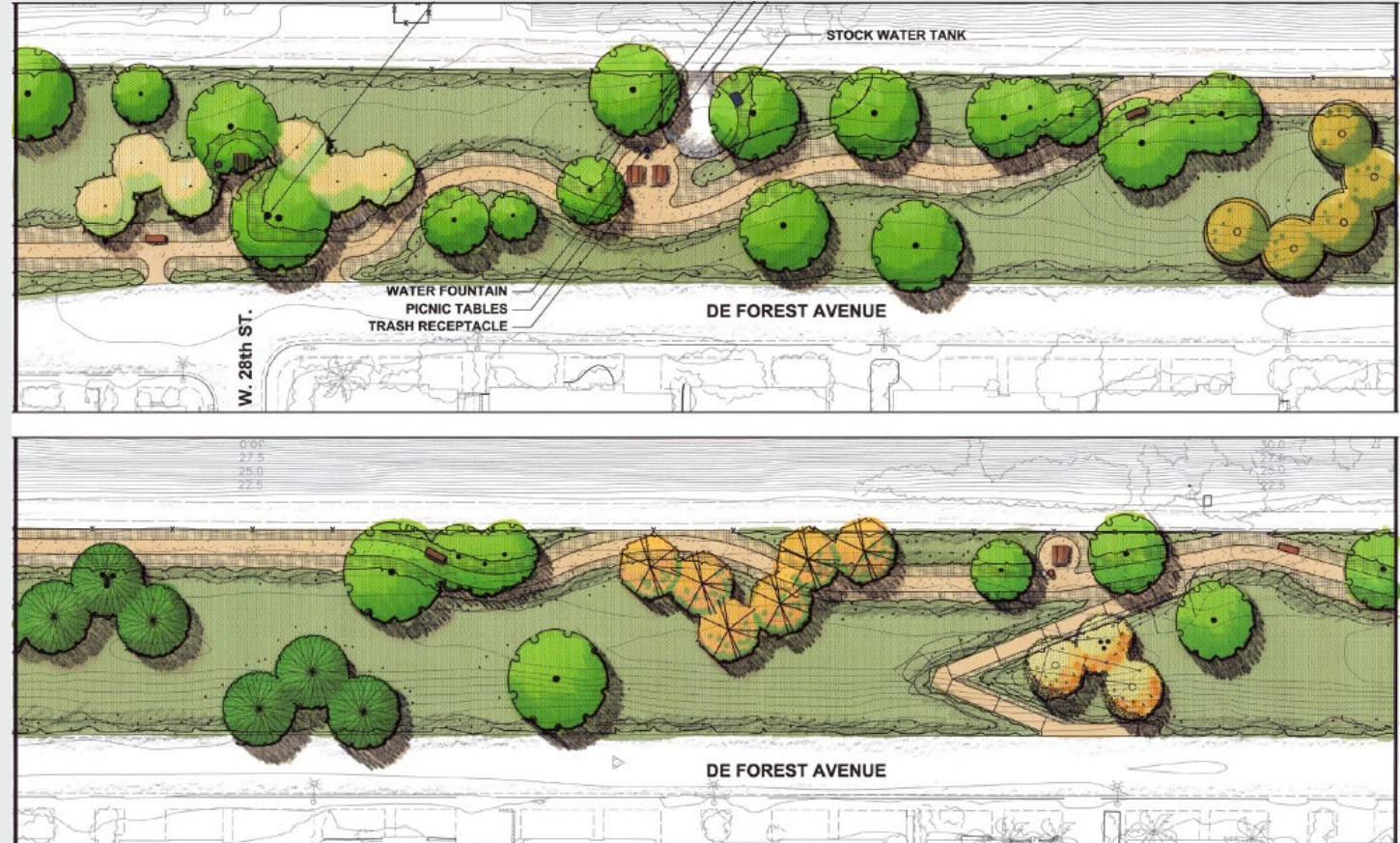

Preliminary Concept between 28th St. and Spring St. –
Presented in August 2011 Homeowners Meeting

Tree & Landscaping Summary (Cont.)

Tree Removals

- Of the 97 existing trees, 36 total trees are to be removed and replaced with new native trees (*conditions as determined by Certified Arborist)
 - 18 Trees in Dead/Poor Condition
 - 11 Trees in Fair Condition
 - 7 Trees in Good Condition (in direct conflict with design to be replaced)
- Of those 36, 20 trees have been removed to date to be replaced at 2:1 ratio (34th Street to Spring Street):
 - 7 – California Pepper
 - 1 – Shamel Ash
 - 4 – Chinese Evergreen Elm
 - 1 – Coast Live Oak
 - 7 – Unknown
- Of those 36, 16 trees to be removed to be replaced at 2:1 ration (Spring Street to 26th Way):
 - 4 – Brazilian Peppers
 - 1 – California Sycamore
 - 7 – Western Cottonwood
 - 1 – Pine
 - 2 – Ficus

Tree & Landscaping Summary

- Of the existing 97 trees, 61 trees will be protected in place, 16 of which design plans were modified to avoid removal.
 - 22 – California Pepper
 - 12 – California Sycamore
 - 10 – Western Cottonwood
 - 7 – Chinese Evergreen Elm
 - 3 – Eucalyptus
 - 2 - Brazilian Pepper
 - 2 – Shamel Ash
 - 1 – English Walnut
 - 1 – Pine
 - 1 – Deodar Cedar



Image 1. North of 27th Street –
3 California Sycamore & 3 California Pepper Trees
protected in place due to design modification



Image 2. North of 26th Way –
4 California Pepper Trees protected in
place due to design modification

Tree & Landscaping Summary (Cont.)

Tree Replacements

- At least 96 new native trees will be planted as part of this project, over 2:1 replacement of trees removed:
 - 55 – Engelmann Oak (>150 years life span)
 - 17 – Coast Live Oak (>150 years life span)
 - 12 – California Sycamore (>150 years life span)
 - 12 – California Walnut (50-150 years life span)
- Native trees are important to the wildlife and ecosystem local to Los Angeles and provide the following benefits:
 - Often have less pest problems and less disease
 - Are well-adapted to the local climate resulting in a longer life cycle
 - Native animals including birds and insects are dependent on native trees and plants for food and shelter that they have adapted to for many years
 - Longer life cycles, less maintenance and increases public safety

Tree & Landscaping Summary (Cont.)

Native Shrubs

- In addition to native trees, the project scope also includes native shrubs that will both beautify and promote wildlife in the area:

- Deer Grass
- Coast Sunflower
- Pitcher Sage
- Black Sage
- California Buckwheat
- California Fuschia
- California Wild Rose
- Blue Bush Lupine
- Showy Penstemon
- Golden Yarrow
- Purple Sage
- White Sage
- Hollyleaf Redberry
- Heartleaf Penstemon



Deer Grass



Coast Sunflower



Pitcher Sage



Black Sage



California Buckwheat



California Fuschia

Wrigley Greenbelt Existing Conditions – North End by 34th Street

Image 1. View looking northward towards 34th Street (January 2021)



Image 2. View looking southward towards 32nd Street (January 2021)

Wrigley Greenbelt Project Rendering – 34th Street Entrance Rest Area



Conservation Corps of Long Beach (CCLB) Partnership

- In keeping with the City of Long Beach and CCLB commitment to sustainability, as part of CCLB Cal Fire Urban Forestry program, lumber produced by this project will be used for other community projects within the City.
- This project will include on the job training for local at-risk young adults 18–25 years of age.
- The participants will be trained and given valuable job skills associated with landscape construction, irrigation installation, arboriculture, and drought tolerant landscaping.



Project Construction Timeline

- Pre-Construction Activities: January – February 2021
- Construction Start – March 2021
 - Stopped all tree activity March 19
 - Community Meeting held April 7
 - Continue with tree operations to be completed by end of April
- Construction End (City of Long Beach Grant Funded Tasks) – July 2021
- Construction End (CCLB Grant Funded Tasks) – Winter 2021

A nighttime photograph of the Long Beach skyline. The city lights, including several tall buildings and palm trees, are reflected in the calm water in the foreground. A semi-transparent white rectangular box is centered over the image, containing the word "Questions?".

Questions?